

Levo

Dynamic monitor arm for single screen
GMA921



Features

- One touch height adjustment with smooth gas lift
- Innovative connector pin and locking cover – effortless conversion from single to dual and vice versa
- Easy head adjustment with ball joint
- Quick-release 75mm/100mm VESA mounting plates with hand-turn fixing screws
- Optional 180° rotation stop
- High capacity integrated cable management
- Tension adjustment indicator helps reduce office installation times
- Adjustment hex keys stored in base
- Optional through-desk clamp - sold separately
- Desk edge and through-desk clamps, tightened from above desktop
- Available in black or white
- Plastic free packaging

Dimensions	See pages 2 and 3
Capacities	Supports screens 2-10kg
Desktop Thickness	10-43mm
Weight	2.08kg
Materials	Steel, plastic
Warranty	5 years
Boxed Dimensions	W770 x D180 x H140 mm
Boxed Weight	3kg
Outer Box Dimensions - 4 units	W790 x D380 x H305 mm
Outer Box Weight - 4 units	13kg

Sustainability

Material	Material Content (%)	Recycled Content (%)	Recyclability (%)
Steel	16.92%	0%	100%
Aluminium	75.49%	0%	100%
Plastic	8.30%	5%	100%



Through-desk clamp
sold separately
GMA9TD-BK

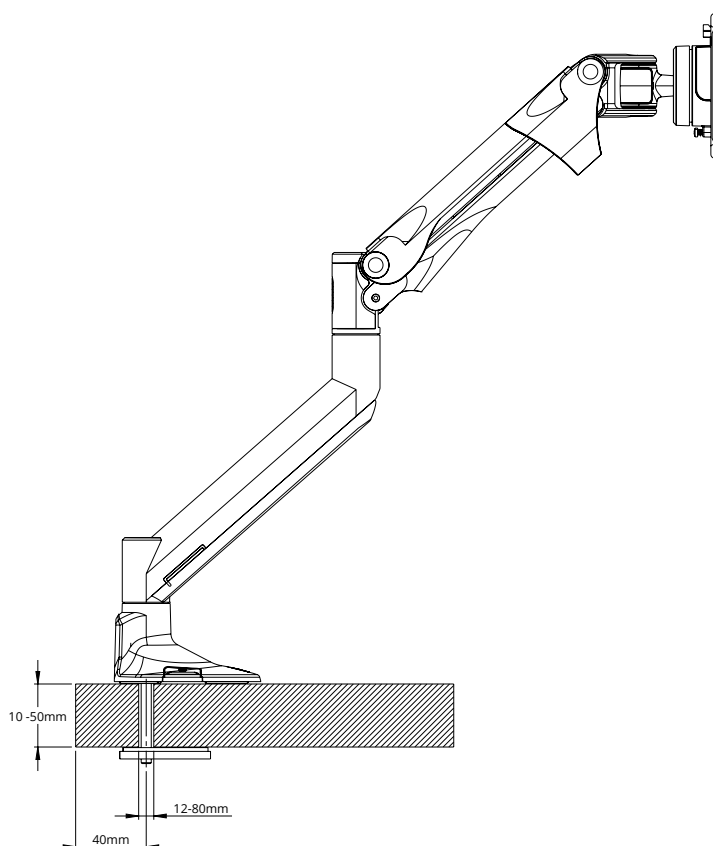
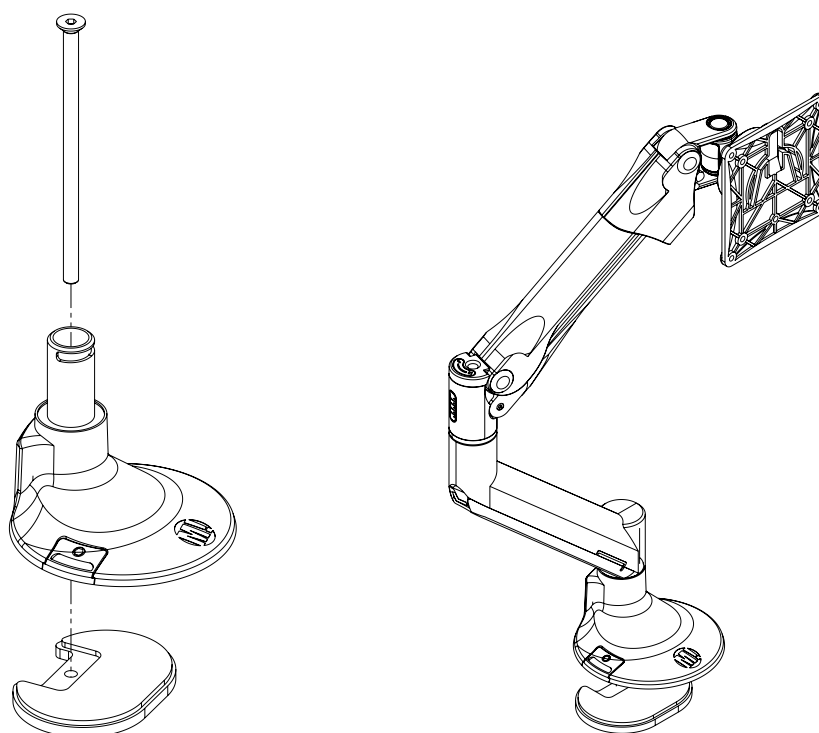

Dimensions

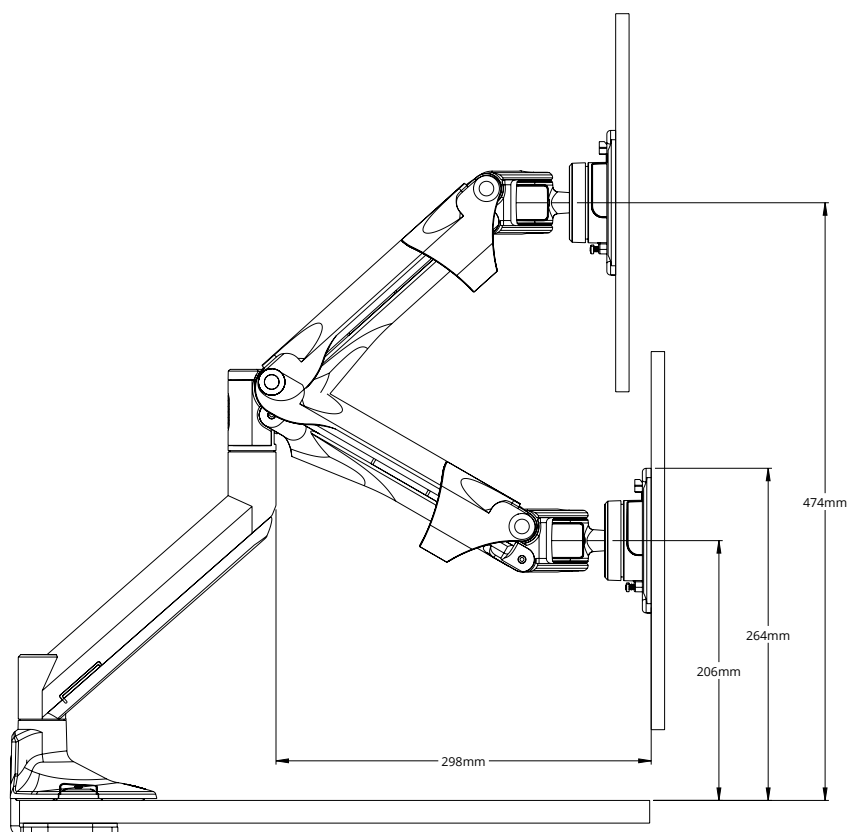
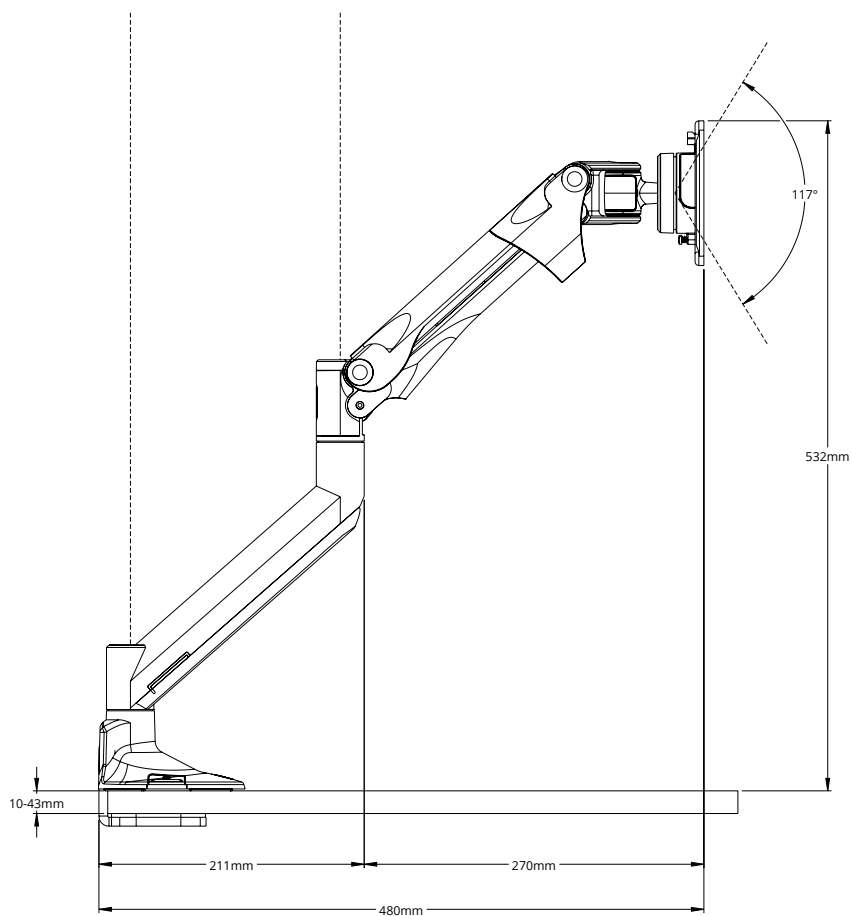
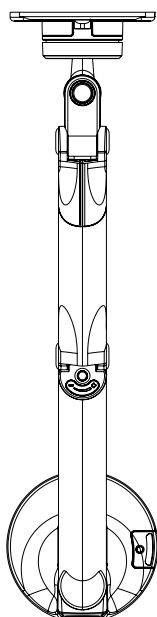
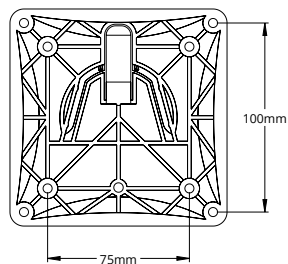

Levo Twin Rail

Twin/dual screen rail VESA attachment
TSR902-BK



Levo monitor arm
sold separately
GMA921

Features

Innovative connector pin and locking cover – effortless conversion from single to dual and vice versa

Compatible with 2 screens weighing 1-4kg each

Quick-release 75mm/100mm VESA mounting plates with hand-turn fixing screws

Fits up to 27" monitors

Tactile tilt and rotation adjustment

Removable adjustment handle

Easy install - no tools required!

Available in black only

Plastic free packaging

Dimensions	See page 2
Capacities	Supports 2 screens 1-4kg Up to 730mm max. screen width
Weight	1.03kg
Materials	Steel, plastic
Warranty	5 years
Boxed Dimensions	W870 x D190 x H117 mm
Boxed Weight	2.2kg
Outer Box Dimensions - 4 units	W890 x D400 x H260 mm
Outer Box Weight - 4 units	9.8kg

Sustainability

Material	Material Content (%)	Recycled Content (%)	Recyclability (%)
Steel	5.45%	0%	100%
Aluminium	72.73%	0%	100%
Plastic	21.82%	5%	100%



Dimensions

